



NHRA CHAMPIONSHIP DRAG RACING

10267 East U.S. Hwy 136
INDIANAPOLIS, IN 46234

NHRA Requirements for Manifold/Supercharger Studs

This requirement is effective 01/01/2015

- Material must be 7075-T6 Aluminum.
- Stud must be white or silver in color only.
- In the middle portion of the stud, there must be a thin point with a diameter no greater than 0.315".

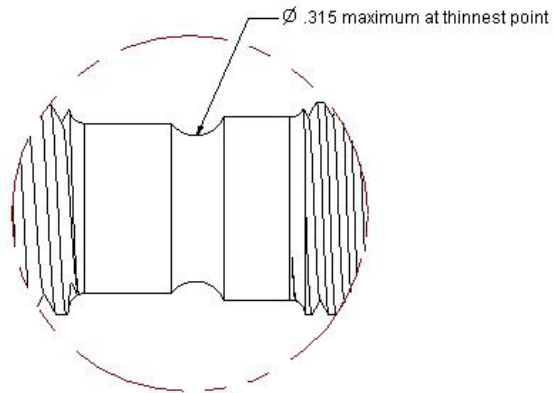

Detail A

